

Assembly Sheet for CL12A5

CONTENTS:

1 x PL46
(Plastic Wall Strip)



6 x CL-MC
(Mounting Clips)



12 x CL-147
(A5 Brochure Holders)



3 x CL-SB
(Supporting Bracket)



18 x CL-SJC
(Side Joining Clips)



Important! Please follow the assembly instruction carefully. Please note that the number and type of clips have been provided to configure with the diagram as shown. Any deviation will result in a shortage of the appropriate clips.

STEP 1

Secure wall strip onto wall.
Refer to your builder/handyman for
formats of securing to wall
For Example:-
For mounting onto Gyprock walls,
suggest using 'Wall Mates'.
For concrete/brick walls suggest
using wall plugs etc



STEP 2

Attach the two
Mounting Clips into
top keyholes of the
first pocket

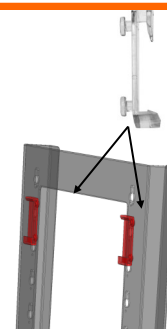

STEP 3

Attach holder
onto the wall strip

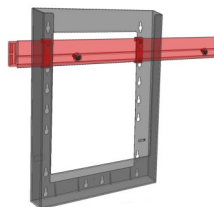

STEP 4

For subsequent pockets
attach Side Joining Clips into
the keyholes (at desired overlap
spacing, free end facing out-
wards) to both sides of the hold-
er

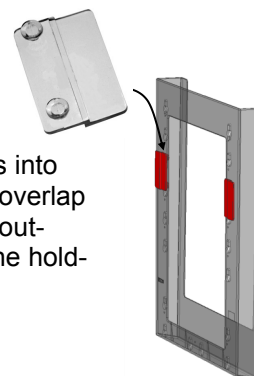

STEP 5

Slide the back of the
pocket onto the front of the
pocket already mounted to
Wall Strip

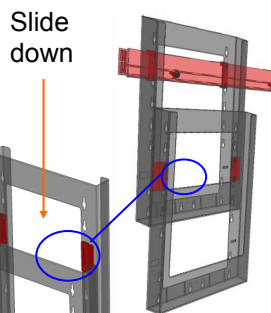

Down Joining Clips grip the
face of the preceding pocket.

Go down 4 levels of pockets

STEP 7 Repeat 2 more columns

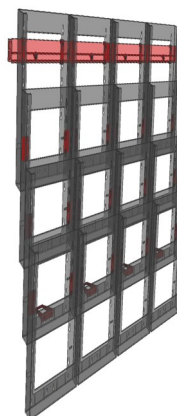

STEP 6 Fit

Supporting
Bracket onto the
back of
third pocket

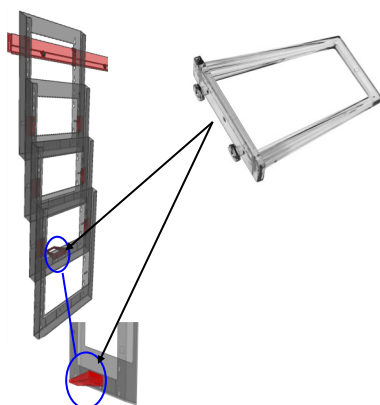

YouTube Video

Assembly of Cliplock™ Standard Wall System (1m 51 sec)
<http://www.youtube.com/watch?v=3ltiNbPFEPY>