

# Assembly Sheet for CL16DL

## CONTENTS:

1 x PL46  
(Plastic Wall Strip)



16 x CL-103  
(DL Brochure Holders)



4 x CL-SB  
(Supporting Bracket)



8 x CL-MC  
(Mounting Clips)



24 x CL-SJC  
(Side Joining Clips)



**Important! Please follow the assembly instruction carefully. Please note that the number and type of clips have been provided to configure with the diagram as shown. Any deviation will result in a shortage of the appropriate clips.**

### STEP 1

Secure wall strip onto wall.  
Refer to your builder/handyman for formats of securing to wall  
For Example:-  
For mounting onto Gyprock walls, suggest using 'Wall Mates'.  
For concrete/brick walls suggest using wall plugs etc



### STEP 2

Attach the two Mounting Clips into top keyholes of the first pocket

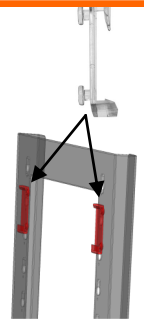

### STEP 3

Attach holder onto the wall strip



### STEP 4

For subsequent pockets attach Side Joining Clips into the keyholes (at desired overlap spacing) to both sides of the holder

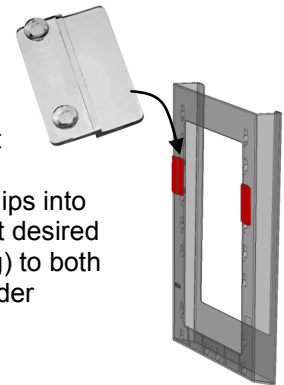

### STEP 5

Slide the back of the pocket onto the front of the pocket already mounted to Wall Strip

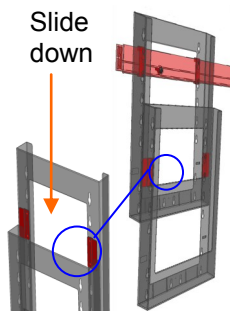

Down Joining Clips grip the face of the preceding pocket.

Go down 4 levels of pockets

### STEP 7

Repeat another 3 more rows

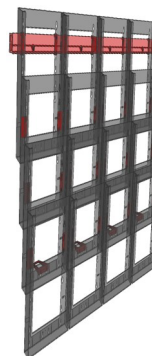

### STEP 6

Fit Supporting Bracket onto the back of third pocket

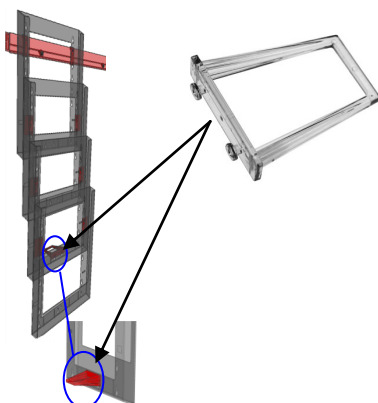

### YouTube Video

Assembly of Cliplock™ Standard Wall System (1m 51 sec)  
<http://www.youtube.com/watch?v=3ltiNbPFEPY>