

# Assembly Sheet for CL32 DL

## CONTENTS:

2 x PL46  
(Plastic Wall Strip)



16 x CL-MC  
(Mounting Clips)



32 x CL-103  
(DL Brochure Holders )



8 x CL-SB  
(Supporting Bracket)



48 x CL-SJC  
(Side Joining Clips)



**Important! Please follow the assembly instruction carefully. Please note that the number and type of clips have been provided to configure with the diagram as shown. Any deviation will result in a shortage of the appropriate clips.**

### STEP 1

Secure wall strip onto wall.  
Refer to your builder/handyman for  
formats of securing to wall  
For Example:-  
For mounting onto Gyprock walls,  
suggest using 'Wall Mates'.  
For concrete/brick walls suggest  
using wall plugs etc



### STEP 2

Attach the two  
Mounting Clips into  
top keyholes of the  
first pocket

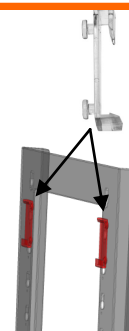

### STEP 3

Attach holder  
onto the wall strip



### STEP 4

For subsequent  
pockets attach Side  
Joining Clips into the  
keyholes (at desired  
overlap spacing) to both  
sides of the holder

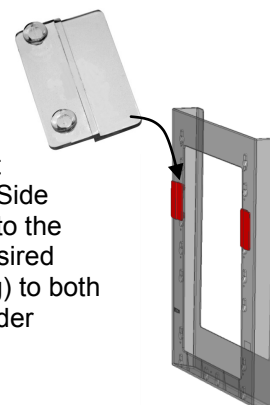

### STEP 5

Slide the back of the  
pocket onto the front of  
the pocket already mounted to  
Wall Strip

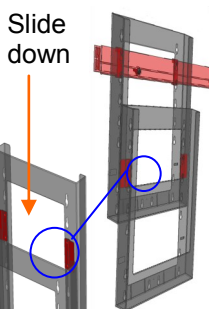

Down Joining Clips grip the  
face of the preceding pocket.

Go down 4 levels of pockets

### STEP 7

Repeat another 7 more rows

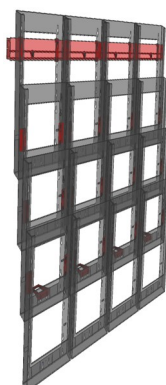

### STEP 6

Fit Supporting  
Bracket onto the  
back of  
third pocket

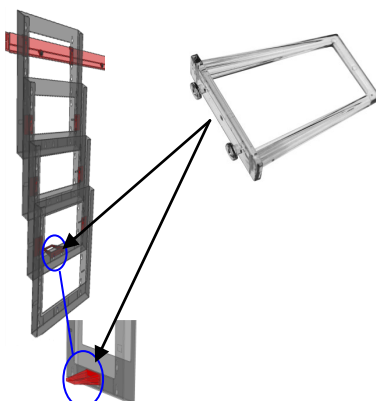

### YouTube Video

Assembly of Cliplock™ Standard Wall System (1m 51 sec)  
<http://www.youtube.com/watch?v=3ltiNbPFepY>